



CHALLENGER PRO 1120Wh UPS POWER STATION



GPS1100U USER MANUAL

Thank you for purchasing this Gizzu product. Before operating this product, please ensure that you read the user manual carefully in order to make sure that the best possible performance is obtained.

FEATURES

- 1000W Power Output**
- 2000 Battery Cycles**
- 1120Wh Battery Capacity**
- UPS Functionality**
- Supports Solar Charging (Solar Panels Sold Separately)**
- Ideal Solution For Power Outages**
- Power Various Appliances & Devices**
- Power Wherever & Whenever You Need It**
- Fast Charge In Under 2 Hours**
- Pure Sine Wave**

PACKAGE CONTENTS

1x Gizzu Challenger Pro 1120Wh UPS Power Station
1x AC Charging Cable
1x Car Charging Cable
1x User Manual

SPECIFICATION

Model	GPS1100U	
Charging	Charging Input	Charging Time
	AC Input	230V/50Hz 800W Max (1.8hrs)
	DC Input	11V-50V 300W Max (6-7hrs)
Internal Battery Type	Lithium Iron Phosphate (LiFePO4)	
Battery Capacity	1120Wh, 22.4V 50Ah	
Inverter	Pure Sine Wave	
AC Output	2x 230V/50Hz 1000W Rated	
DC Outputs	1x Type-C 100W PD Port (5V/3A, 9A/3A, 12V/3A, 15V/3A, 20V/5A)	
	2x Type-C 30W PD Ports (5V/3A, 9V/3A, 12V/2.5A, 15V/2A, 20V/1.5A)	
	1x USB QC3.0 Port (5V/3A, 9V/2A, 12V/1.5A, 5V/4.5A, 4.5V/5A)	
	2x USB 2.0 Ports (5V/2.4A)	
	1x Car Socket Port (12V/10A)	
2x DC5521 Ports (12V/10A)		
Battery Management System	Yes	
Lifespan	2000 Charging Cycles	
Protection Features	Short-Circuit & Over-Current Protection	
	Over-Voltage & Under-Voltage Protection	
	Over-Load & Temperature Protection	
Dimensions	38x26x29cm	
Weight	14kg	
Warranty	2 Year	

Note: The maximum concurrent rated output for this device is 1000W. Please double-check the watt requirement of the appliance you want to power before connecting it to your Gizzu Power Station.

INTRODUCTION

Deliver power wherever and whenever you need it with the portable Gizzu Challenger Pro 1120Wh UPS Power Station. The Challenger Pro offers 1120Wh of battery capacity, it's great for keeping your devices charged during outdoor adventures and powering essential household devices during loadshedding. The elegant design is durable, robust, and light enough to carry around. It includes an LED Light that can provide light of its own when needed.

The Gizzu Challenger Pro 1120Wh UPS Power Station features two South African 3-pin output AC plugs, one 100W PD port, two 30W PD ports, three USB ports, two DC ports, and a car socket port. These ensure that you can charge or power multiple devices simultaneously. Along with Pure Sine Wave technology, which is better suited to powering sensitive electronics, the Challenger Pro also features UPS functionality. This means that the Challenger Pro seamlessly switches over to battery power during loadshedding or a power outage, resulting in zero downtime for your connected essential devices.

The Gizzu Challenger Pro 1120Wh UPS Power Station features Lithium Iron Phosphate (LiFePO4) batteries that recharge from 0% to 100% in under 2 hours and has up to 2000 charging cycles. You can recharge the Challenger Pro in multiple ways - draw power from your car, solar panel, or from traditional wall sockets at the home or office.

A battery management system helps to proactively monitor and manage the rechargeable battery. In addition, the Challenger Pro also features safety features like short-circuit, over-current, over-voltage, under-voltage, over-load, and temperature protection.

Please note:

The total power consumption for all connected appliances must be less than 1000W prior to connecting the device to the AC port. If the power requirement draw exceeds 1000W, the device will shut down and this may cause damage.

ATTENTION

Do not attempt to use the equipment before you become familiar with the entire operating instructions. Keep these instructions for future use. Attention should be paid, in particular, to safety guidelines.

Please adhere to the technical requirements of AC devices you are about to attach to your Gizzu Challenger Pro UPS Power Station. Failure to adhere to these requirements, or incorrect useage thereof, may cause personal injury or harm to others, as well as potentially resulting in damage to equipment.

Observe in particular the safety instructions given on the labels that are affixed to the device. Do not remove or damage these labels. This device must not be used by children.

Other uses or alterations to the device or use other than the intended purpose will immediately void the warranty and will pose a potentially serious health risk. The manufacturer is not liable for damages caused by any use other than the intended purpose.

USAGE AND HANDLING GUIDELINES

- For maximum performance, be sure to charge the Gizzu Challenger Pro UPS Power Station, if it has been unused and in storage for more than 3 months.
- Keep this device away from heat sources and direct sunlight at all times, whilst in use as well as when in storage.
- Do not attempt to connect this product to devices above the rated wattage load.
- Be sure to use this product in a well-ventilated environment.
- Opening the device will result in the warranty being voided.

GENERAL SAFETY INSTRUCTIONS

- Do not operate the Gizzu Challenger Pro UPS Power Station with damaged cords, plugs, or output cables. This may cause a short-circuit and risk causing a fire. It may also damage the product.
- Please return the power station to a qualified service provider for repair or maintenance. Do not disassemble the portable power station by yourself, as wrong disassembly method may cause the risk of fire or electric shock.
- We strongly recommend the use of a Gizzu Universal Voltage Protector with this device.
- Please charge the product in a well-ventilated place, do not obstruct the air circulation.

CAUTION:

- Do not use this product if the ambient temperature exceeds 50°C due to risk of battery failure (or battery overheating). Conversely, using this product when the ambient temperature is below -20°C, the battery performance may be significantly reduced.
- Do not use this device around environments with strong static electricity or magnetic fields.
- Do not continue to use the device if it has been dropped or struck by an external impact.
- This product cannot be carried on an airplane.
- This product is not recommended for use in the supply of safety-related medical emergency equipment, including but not limited to medical grade ventilators (hospital version CPAP: Continuous Positive Airway Pressure), Artificial lung (ECMO, Extracorporeal Membrane Oxygenation), etc. In addition, the CPAP is used in the home environment and can be used normally. Generally, it does not require continuous professional monitoring. Please follow the doctor's advice and consult the manufacturer for the restrictions on the use of related equipment. If it is used for general medical equipment, please pay attention to the power status to ensure that the power is not exhausted.
- Power supply products will inevitably produce electromagnetic fields when they are used, which may affect the normal operation of implantable medical devices or personal medical devices, such as pacemakers, cochlear implants, hearing aids, defibrillators, etc. If these medical devices are used, please consult the manufacturer for restrictions on the use of these devices to ensure that the product works at a safe distance from implanted medical devices.
- Large electronic devices may have fluctuating power requirements. When these devices draw more than the rated output of the Gizzu Challenger Pro UPS Power Station, it may cause it to shut down automatically. Please pay attention to your device's full range of power consumption before connecting it to the Gizzu Challenger Pro UPS Power Station.

PRODUCT BATTERY DISCARD

- Please discard this unit in designated battery recycling bins only.

DISCLAIMER

The manufacturer will not be held responsible for damages caused by:

- Incorrect connection and/or use.
- Impact of external forces, damage to equipment and/or damage to parts of the device by mechanical impact or load.
- Any change made to the device.
- Using the device for purposes other than those described in this manual.
- Subsequent damage due to unspecified and/or inappropriate use and/or faulty accumulators.
- Humidity and/or insufficient ventilation.
- Unauthorized opening of the device.

NOTE: The above mentioned will immediately void the warranty of the product.

STATEMENT OF LIMITED WARRANTY

This warranty covers a product that proves defective because of improper material or workmanship during the warranty period.

Exclusions include problems caused by environmental conditions, malfunctions or damage due to negligence or mishandling of the equipment. For warranty claims and repair, please contact your local authorized reseller/service center.

LED SCREEN INDICATOR LEGEND

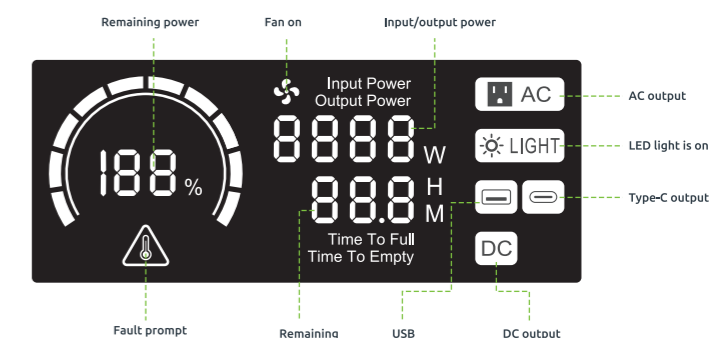

	Power on display	Press and hold the power button for 3s to turn on the unit. The fans will begin to spin and the LED display will turn on. If the output power is on and the power is 0, the Time To Empty display will show 999H. After 30s of inactivity, the device will automatically shut down.
	AC output	1. When the AC output port is enabled, the LED indicator will switch on. When a load is connected, the output power and discharge time is displayed. 2. When the AC output is overloaded, it will automatically turn off and the AC Indicator LED will flash for 10s. Once the fault is removed, the AC output is automatically restored. You can also press the AC button to restore the AC output.
	Lighting mode	When you turn the light on, the relevant light indicator will also turn on, as well as the output power and the time remaining until power is discharged. There are 4x light modes (click to toggle).
	DC output	When the DC output, is turned on, the DC light is displayed, as well as the output power and discharge times.
	PD output	When the PD100W port is used for output, the indicator is on, and the output power and discharge time are displayed at the same time.
	Output display	When the DC output is turned on, three characters are lit (DC, USB, and Type-C), and the output power and discharge time are displayed.
	Fault prompt	In case of failure, the respective output port will be turned off immediately, and the corresponding port symbol and the indicator light will flash. It will be turned off without affecting other outputs.

DC	AC	Fan on
<p>The first fan turns on automatically when DC input exceeds 125W or when AC output exceeds 100W.</p> <p>The second fan turns on automatically when DC input or AC output exceeds 200W.</p> <p>The third fan turns on automatically when DC input or AC output exceeds 300W.</p> <p>If the battery temperature exceeds 50°C, all three fans will turn on at full speed (irrespective of charging or discharging power wattage).</p> <p>The fans will stop rotating 2s after the Gizzu Challenger Pro UPS Power Station drops below the thresholds indicated above.</p>		

UPS FUNCTIONALITY

This product features UPS functionality, which means that you can connect it to an AC wall power source while simultaneously using its AC outlet. This means that when power is working normally, your devices are powered by AC power (not the battery). When loadshedding or power failures occur, the Gizzu Challenger Pro UPS Power Station will automatically switch to battery (within 10ms of the power being cut off).

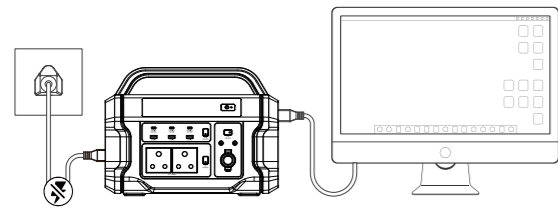

-8-

PRODUCT SCHEMATIC & LEGEND

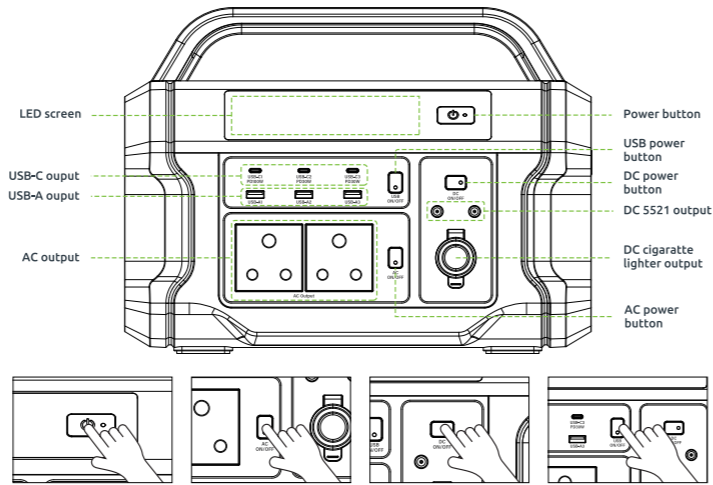

- | | | | |
|---|---|---|--|
| <p>Power button
Hold down the power button for 3s to turn the Gizzu Challenger Pro UPS Power Station on. Once on, the LED display screen lights up. When on, press and hold for 3s to shut the device down. While the device is charging, the power button will not switch the device off. First ensure you unplug the charging input AC to ensure the device will shut down normally.</p> | <p>AC power button
Press the AC power button once to turn on the AC output. The AC LED indicator will turn white and the display icon will light up. Press the AC power button again to turn AC output off. The AC LED indicator and display icon will no longer be displayed.</p> | <p>DC power button
Press the DC power button once to turn on the DC output. The DC LED indicator will turn white and the display icon will light up. Press the DC power button again to turn DC output off. The DC LED indicator and display icon will no longer be displayed.</p> | <p>USB power button
Press the USB power button once to turn on the USB output. The USB LED indicator will turn white and the display icon will light up. Press the USB power button again to turn USB output off. The USB LED indicator and display icon will no longer be displayed.</p> |
|---|---|---|--|

-9-

PRODUCT SCHEMATIC & LEGEND

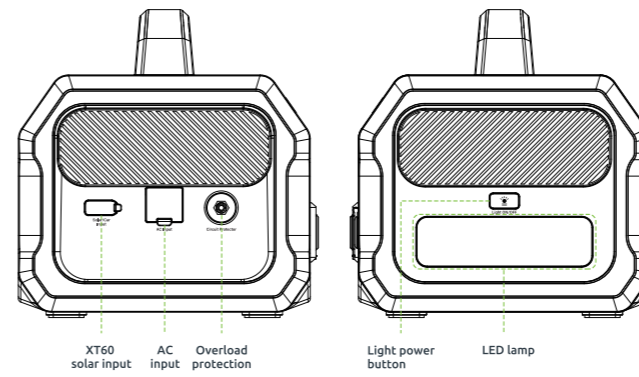

- | | |
|----------------------------------|--|
| <p>Light power button</p> | <p>Press the light power button once to turn on the LED lamp. Press the light power button again to toggle half on-full on-SOS-flash.</p> <p>SOS distress signal: 3 short, 3 long, and 3 short.</p> <p>Flash signal: On for 200ms and off for 200ms.</p> <p>Press and hold the light power button for 2s to turn off the LED lamp.</p> |
|----------------------------------|--|

-10-

SOLAR SETUP

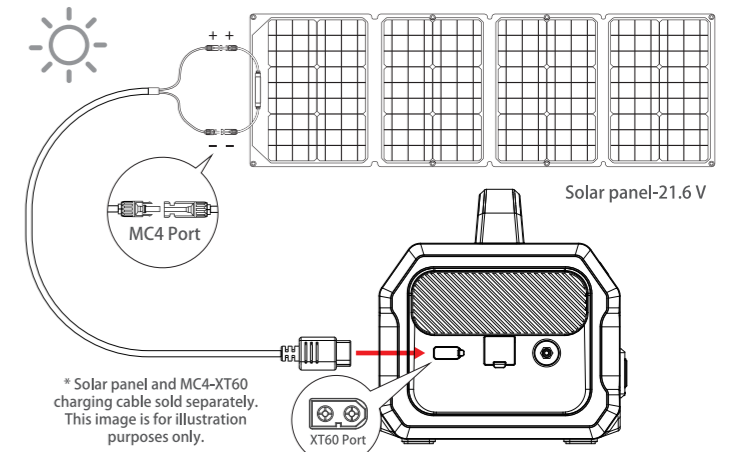

- Connect your solar panel via MC4-XT60 solar charging cable to the Gizzu Challenger Pro UPS Power Station's XT60 input (singular solar panel only, multiple panels in series is not supported). Please note that you can only connect up to 2 solar panels in parallel.
- If two solar panels need to be connected, do so with a parallel connection. Connect the MC4 charging cable to your solar panel before connecting the XT60 interphase connector solar charging line to the XT60 interface of the Gizzu Challenger Pro UPS Power Station

Note: Parallel cables are not standard and need to be purchased separately.

The Gizzu Challenger Pro UPS Power Station is rated for an input solar charge from 11 to 50V. Over-voltage protection will be triggered if the wattage input exceeds 50W. High voltages may cause damage to your Gizzu device and invalidate its warranty.

-11-

料号编码		设计制作	刘小俊
尺寸	100*130mm 公差:±0.5mm	资料提供	受控图档
材质	128G铜版纸 彩色印刷	外贸审核	潘秋霞
工艺	装订方式:钉骑马钉	研发部审核	李雄
备注	有任何疑问及时联系相关作业人员	制作时间	2020/06/18
页数	12P		